

APPLY BEAD MASTIC TO INSIDE OF HOLES

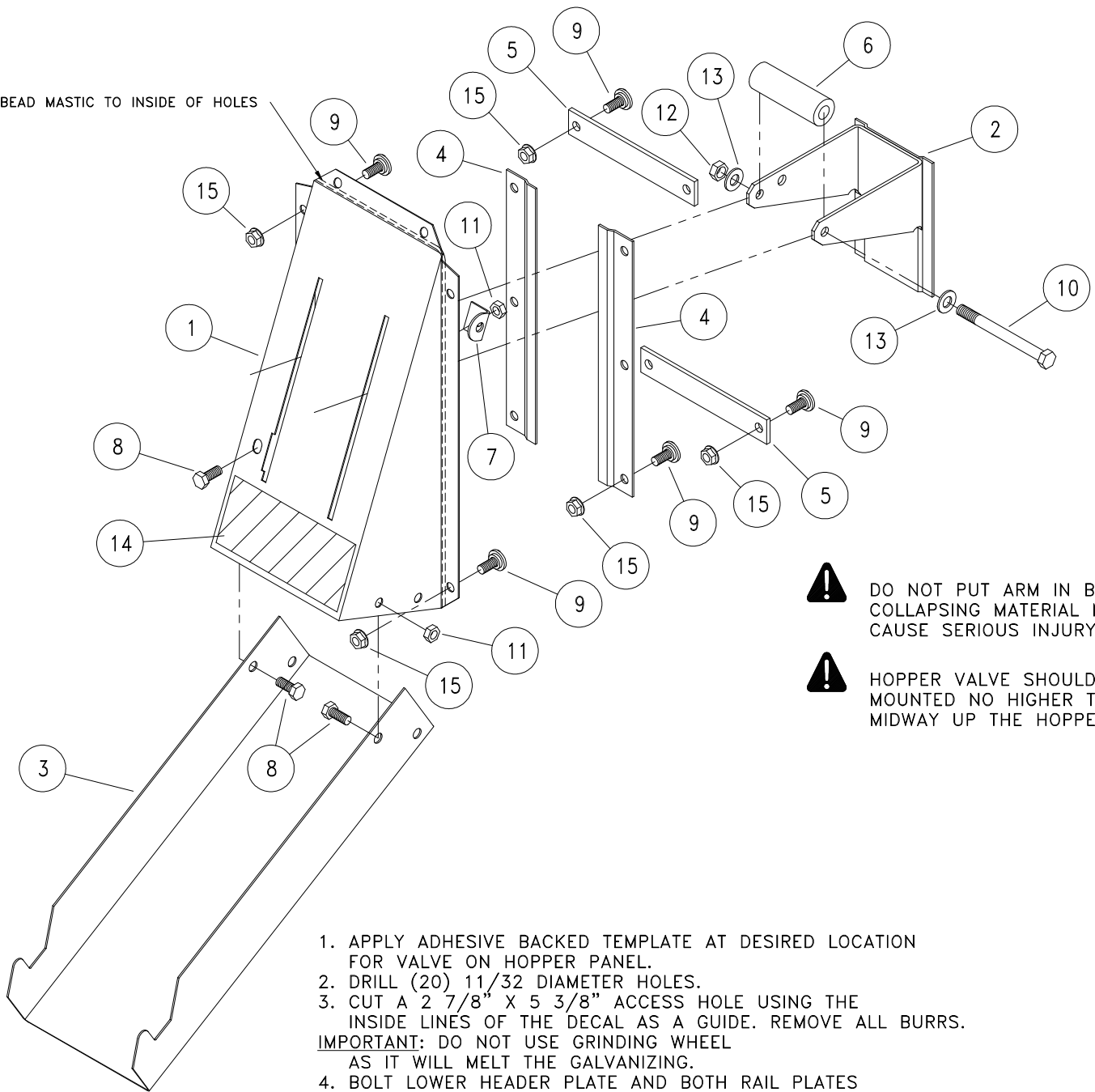

DO NOT PUT ARM IN BIN.  
COLLAPSING MATERIAL MAY  
CAUSE SERIOUS INJURY.



HOPPER VALVE SHOULD BE  
MOUNTED NO HIGHER THAN  
MIDWAY UP THE HOPPER.

1. APPLY ADHESIVE BACKED TEMPLATE AT DESIRED LOCATION FOR VALVE ON HOPPER PANEL.
2. DRILL (20) 11/32 DIAMETER HOLES.
3. CUT A 2 7/8" X 5 3/8" ACCESS HOLE USING THE INSIDE LINES OF THE DECAL AS A GUIDE. REMOVE ALL BURRS.
- IMPORTANT:** DO NOT USE GRINDING WHEEL AS IT WILL MELT THE GALVANIZING.
4. BOLT LOWER HEADER PLATE AND BOTH RAIL PLATES WITH 5/16" HEX BOLTS.
5. INSTALL SLIDE HANDLE INTO RAILS AND BOLT UPPER HEADER PLATE ON.
6. INSTALL LOCK PLATE INTO THE SHROUD AS SHOWN.
7. REMOVE DECAL AND PLACE A BEAD OF MASTIC CAULKING ON OUTSIDE OF BOLT HOLES. PLACE DOUBLE THICKNESS AT TOP CORNERS OF SHROUD.
8. BOLT SHROUD OVER THE SLIDE ASSEMBLY USING (6) 5/16" BIN BOLTS
9. USE 3/8" X 3 1/2" BOLT TO INSTALL HANDLE TUBE ON SLIDE.
10. BOLT CHUTE TO SHROUD USING (4) 5/16" X 3/4" HEX BOLTS

KEY	PART NUMBER	DESCRIPTION	QTY.	KEY	PART NUMBER	DESCRIPTION	QTY.
1	158514	SHROUD	1	9	158312	5/16" NC X 3/4" HOPPER BOLT	16
2	158520	SLIDE HANDLE	1	10	154030	3/8" NC X 4" HEX BOLT	1
3	158510	CHUTE	1	11	154048	5/16" NC HEX NUT	5
4	158511	RAIL PLATE	2	12	154050	3/8" LOCK NUT	1
5	158517	HEADER PLATE	2	13	154066	3/8" FLATWASHER	2
6	158518	HANDLE TUBE	1	14	158523	WARNING DECAL	1
7	158521	LOCK PLATE	1	15	158372	5/16" NC HEX FLANGE NUT	16
8	154008	5/16" NC X 3/4" HEX BOLT	5				

## HOPPER VALVE ASSEMBLY DETAILS

REV A/09-048/9-3-09/GDS

SIoux STEEL COMPANY

GB

1-26-95

158524