

LMF10 LIVESTOCK MINERAL FEEDER

Ref. No.	Part No.	Description	Quantity
1	OF470	1 1/8 Split Ring, Zinc	1
2	PLMF109	Flap Retention Plate, 8"	1
3	PLMF102	Rubber Flap, Mineral Feeder	1
4	PLMF107	5/8" Link Pin	1
5	OF340	5/8 Flat Washer, Zinc	2
6	LMF101	Plastic Body, Red	1
7	OF469	5/8 - 11 Hex Nut, Zinc	1

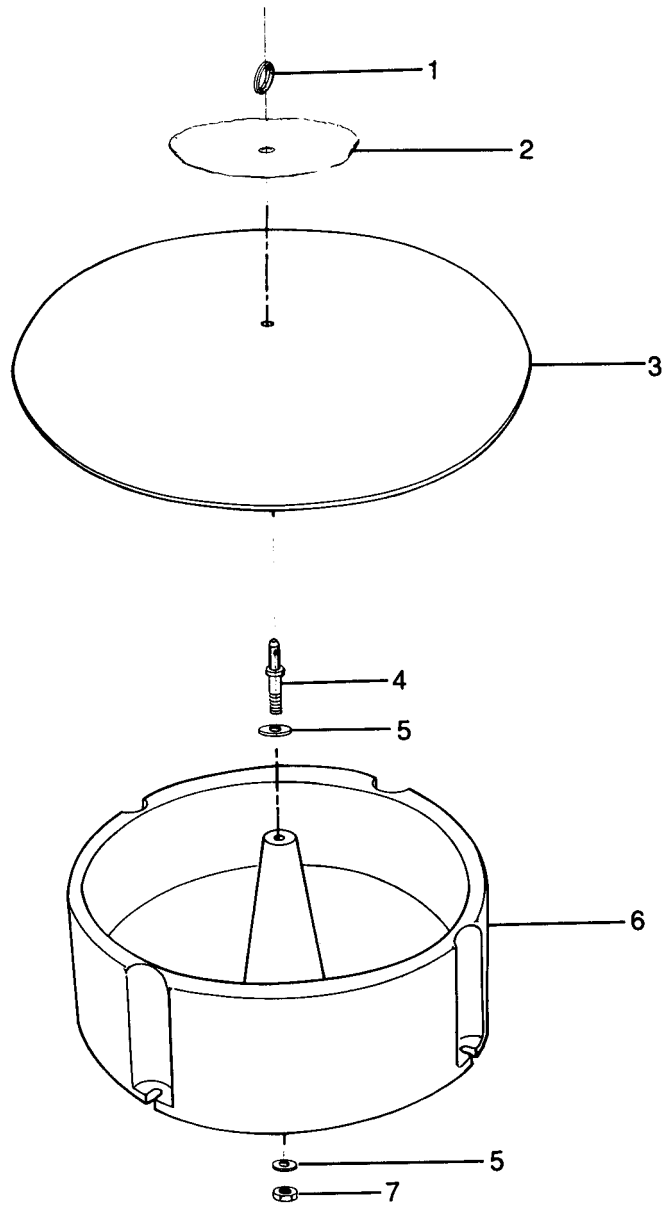

MINERAL FEEDER SPECIFICATIONS						
Model No.	Approx. Capacity		Overall Size Inches (cm)	Eating Height	Overall Height	Shipping Wt. Lbs. (kg)
	Feed	Head				
LMF10	Block 150 lbs. (68.2 kg)	40	44 Dia. (111.8)	11 (27.9)	17.3 (43.9)	47 (21.4)
			Hopper - 33 (83.8)			
	Loose 200 lbs. (90.9 kg)	40	Top; 35 (88.9) Bottom			

Minimal Assembly. Shippable via UPS in 2 parcels – 31 lbs. (14.1 kg) and 16 lbs. (7.3 kg).